

1

2

3

4

5

6

A

A

B

B

C

C

D

D

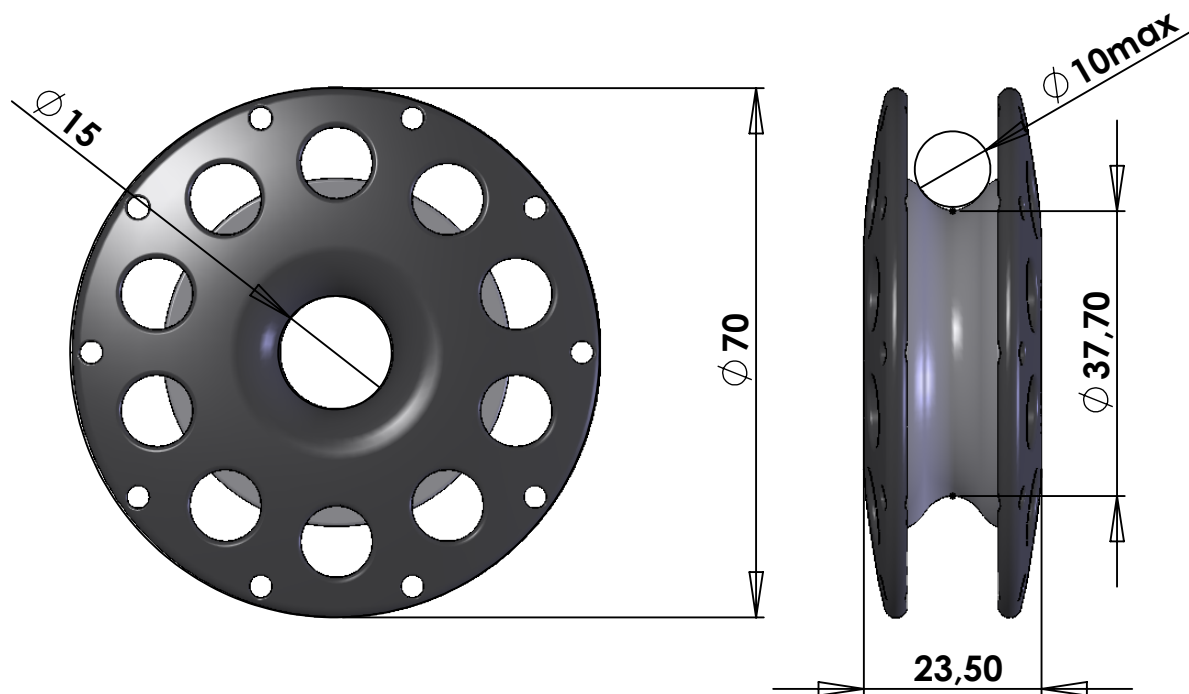

Self-lubricating plain bearings block
Poulie à roulement à palier auto-lubrifié

DATE	VERSION	MATERIAL	WEIGHT	SCALE
19/06/17	V1	Plastic / Aluminium	96g	1/1
MODEL		SAFE WORKING LOAD CHARGE DE TRAVAIL	 www.karver-systems.com	
KB10C		BREAKING LOAD CHARGE DE RUPTURE		
PART NUMBER: PF180031			MORE INFOS ON WWW.KARVER-SYSTEMS.COM	FORMAT A4

1

2

3

4

5

6